



FMT4400

900mm Polymask Dispenser

Product Instruction Manual



T: +44 (0)1582 661993 F: +44 (0)1582 667100 E: sales@fastmovertoolsuk.com

FMT4400

Instruction Manual

Introduction

The FMT4400 is designed to take a 900mm Roll of Polymask.

General Safety Instructions

- 1 Use this tool on a smooth, level, non-slip surface and always keep your working environment clean and tidy.
- 2 Do not use this tool whilst under the influence of drugs, alcohol and intoxicating medication.
- 3 Do not use this tool for any other purpose other than that for which it is intended. This tool is not intended as a tethering point.
- 4 Do not allow children and other unauthorised persons to use this equipment.
- 5 This tool has sharp edges. It is strongly recommended that hand protection is worn when using this tool.
- 6 Always be aware of those around you and keep in mind that your actions have a direct effect on your colleagues and visitors.

Parts Diagram

Part	Description	Qty
1	R/H Side Frame	1
2	L/H Side Frame	1
3	Base	1
4	M8 x 45 Bolt	9
5	Cross Tube	1
6	Axle	1
7	Washer	4
8	Wheel	2
9	Snap Pin	2
10	Brake	2
11	M8 Nut	5
12	Spring	1
13	Rubber Spacers	4
14	M8 x50 Bolt	1
15	Washer	13
16	Roll Hub	2
17	Bushing	2
18	Washer	2
19	Pivot Tube	1
20	M8 x 70 Bolt	1

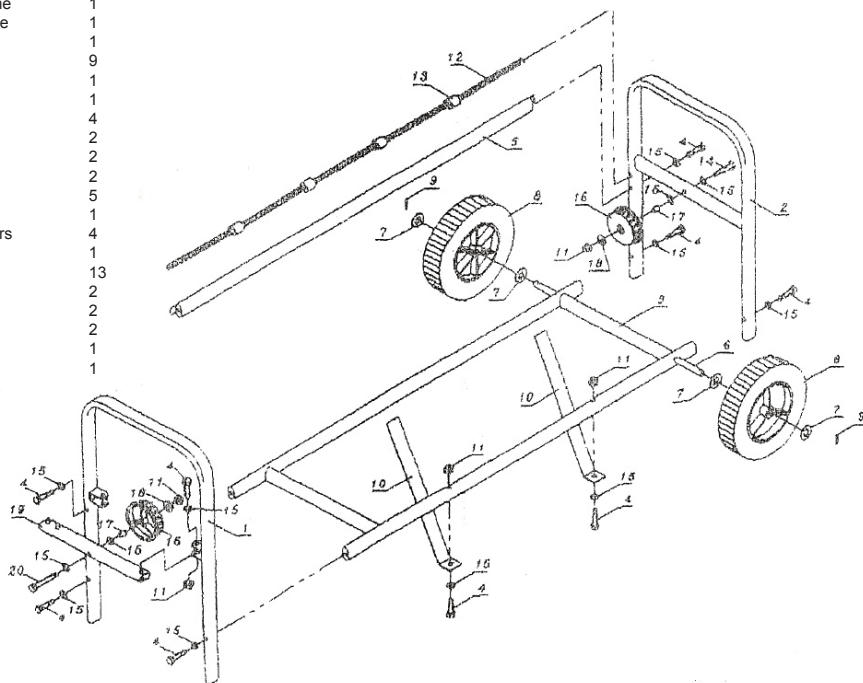

Assembly instructions

Important - Before assembling, note the location of the brake (10), mounting holes in base (3) in relation the Cross Tube (5) and spring (12) mounting holes in the side frames (1) and (2). Assemble as shown in the diagram.

- 1 Attach Side Frame (1) to the Base (3) label side. Use two M8 x 45 Bolts (4). Do not fully tighten.
- 2 Attach side Frame (2) to the Base with two M8 x 45 Bolts (4). Do not fully tighten.
- 3 Attach Cross Tube (5) with the label facing out to lower set of holes in Side Frames with two M8 x 45 Bolts. All bolts can then be tightened.
- 4 Slide axle through base.
- 5 Parts should be fitted to the axle in this order: 7, 8, 7 and 9. Wheels should be fitting with ribbed side facing out.
- 6 Fit two sprung steel brakes (10) to the base using M8 x 45 Bolts and M8 Nuts (11) with the Nut on the upper side of the frame.
- 7 Hook guide spring (12) with rubber spacers (13) into the upper holes in side frame.
- 8 Assemble and instal roll hubs as shown.

Fast Mover Tools Ltd

T: 01582 661993 F: 01582 667100 E: sales@fastmovertoolsuk.com

W: www.fastmovertoolsuk.com