



WS400 LS400
SERIES 2.1

designed by *pininfarina*



P R E C I S I O N P E R F E C T E D



PROVEN
EXPERIENCE
EVOLVED
PERFORMANCE



SERIES 21

INSIDE SERIES 2.1

Integrating advanced atomisation, pressure stability, and handling expertise, Series 2.1 combines proven performance with ergonomic design by Pininfarina, where Italian style meets engineering precision.

Grounded in expertise...

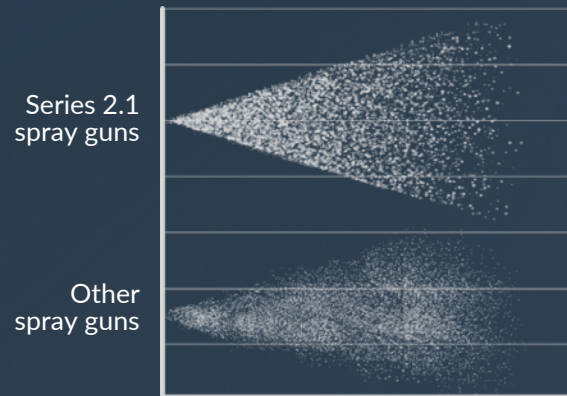

Atomisation

Even droplet distribution
= superior efficiency
= flawless finish.

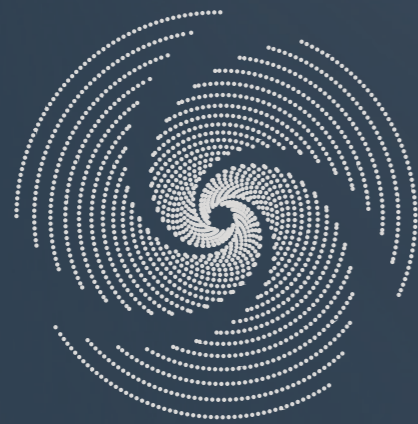

Pressure Stability

Stable pressure output
= uniform atomisation
= perfect consistency.



Handling

Balanced trigger and weight
= reduced fatigue
= enhanced precision.

...evolved for lasting durability.

The spray gun body is engineered with a **premium anodized finish** that maximizes protection and durability. Setting a benchmark in **strength and endurance**, it gives professionals **confidence in steady performance** and holds firm even in the most demanding environments.



TOUGH, WITHOUT COMPROMISE

Durability that drives performance.

Featuring a **high-performing anodised finish**, the spray gun body is engineered to better withstand solvents, support convenient handling, and deliver superior cleanability, combining **robust construction** with practical, **effortless use**.

Designed to excel every day.



Atomisation perfected. Every drop in exactly the right place.

Anest Iwata engineered the Series 2.1 with its signature Split Nozzle™2.0, for flawless atomisation, consistent spray patterns, and smooth, even coverage that minimizes waste and ensures superior finishes.

» Superior coating quality. Confidence in every pass.



Ergonomics designed for comfort and control.

Balanced and naturally shaped to reduce fatigue during extended use. Optimised trigger and grip maintain precision and control throughout every session.

» Reduced fatigue. Maximum control and accuracy.



Efficiency that keeps workflow moving.

Optimised for speed and consistent output. Every coating pass counts, improving productivity without compromising the quality of the finish.

» Higher productivity.
Perfect results, every time.



**DURABLE.
DEPENDABLE.
DESIGNED
TO PAY OFF.**



READY FOR EVERY STAGE

Engineered to fit your process

Whether you're applying basecoat or clearcoat, there's a Series 2.1 model optimised for your job.

Precision for modern basecoats.
Designed for today's one-visit basecoats, the WS-400 Base Series 2.1 delivers an ultra-fine and even atomisation even for difficult colors.
→ Flatter finish, perfect color matching, fewer reworks.

Faster process, better results = more jobs done.

WS-400 BASE

Control and consistency in all conditions.
The LS-400 Base Series 2.1, with HVLP Technology, handles both waterborne and solvent-based basecoats with ease. Stable droplet size = smoother, more predictable application.
→ Less mottling, less waste, more material savings.

Save paint and time = save money.

LS-400 BASE

Gloss and flow, right from the start.
The WS-400 Clear Series 2.1 lays down clearcoat with balance and precision - no tweaking needed.
→ Smooth finish, no excessive build-up and no orange peel.

Less do-overs = more profit and more confidence.

WS-400 CLEAR



PRECISION AND RELIABILITY, FROM START TO FINISH.

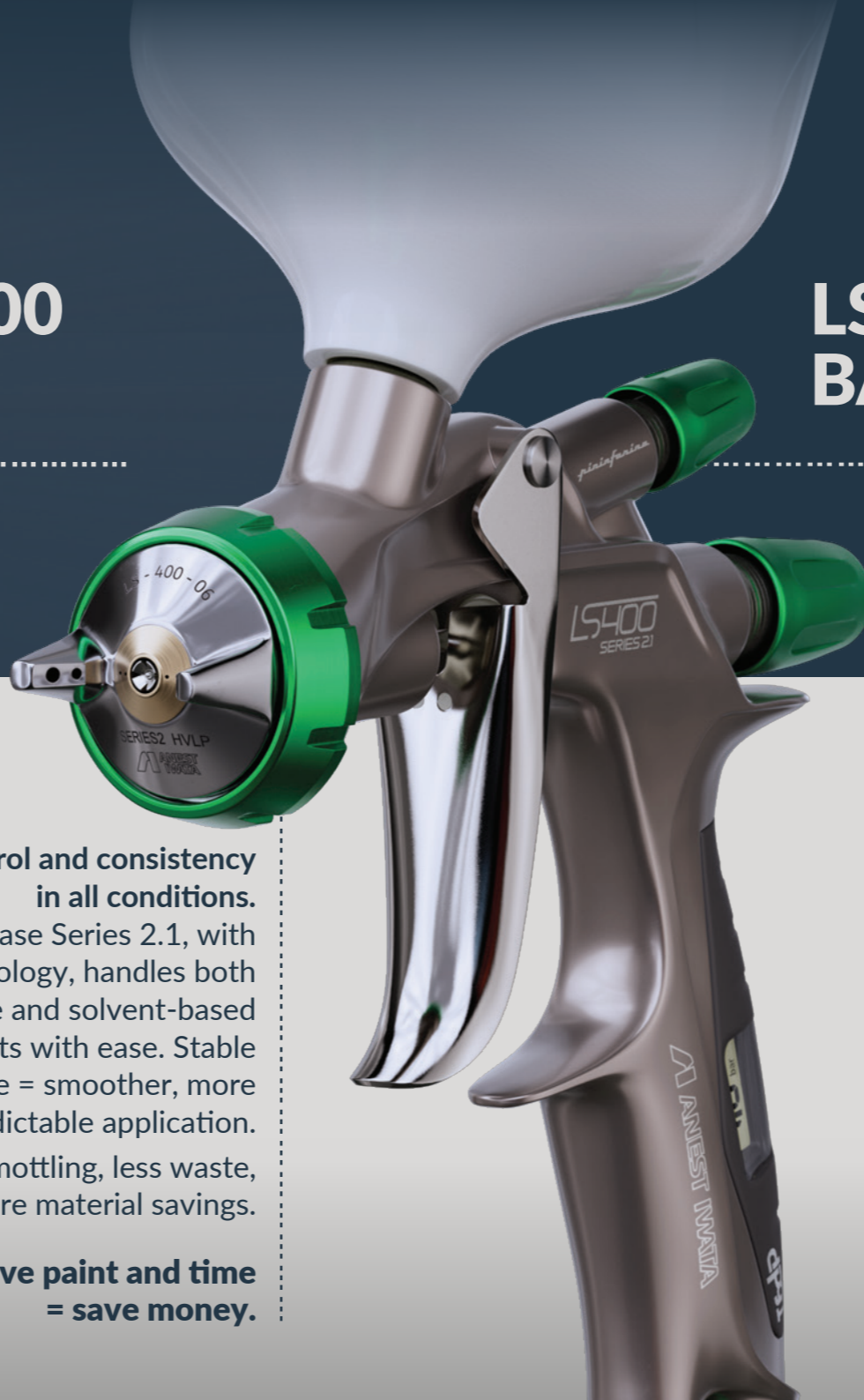
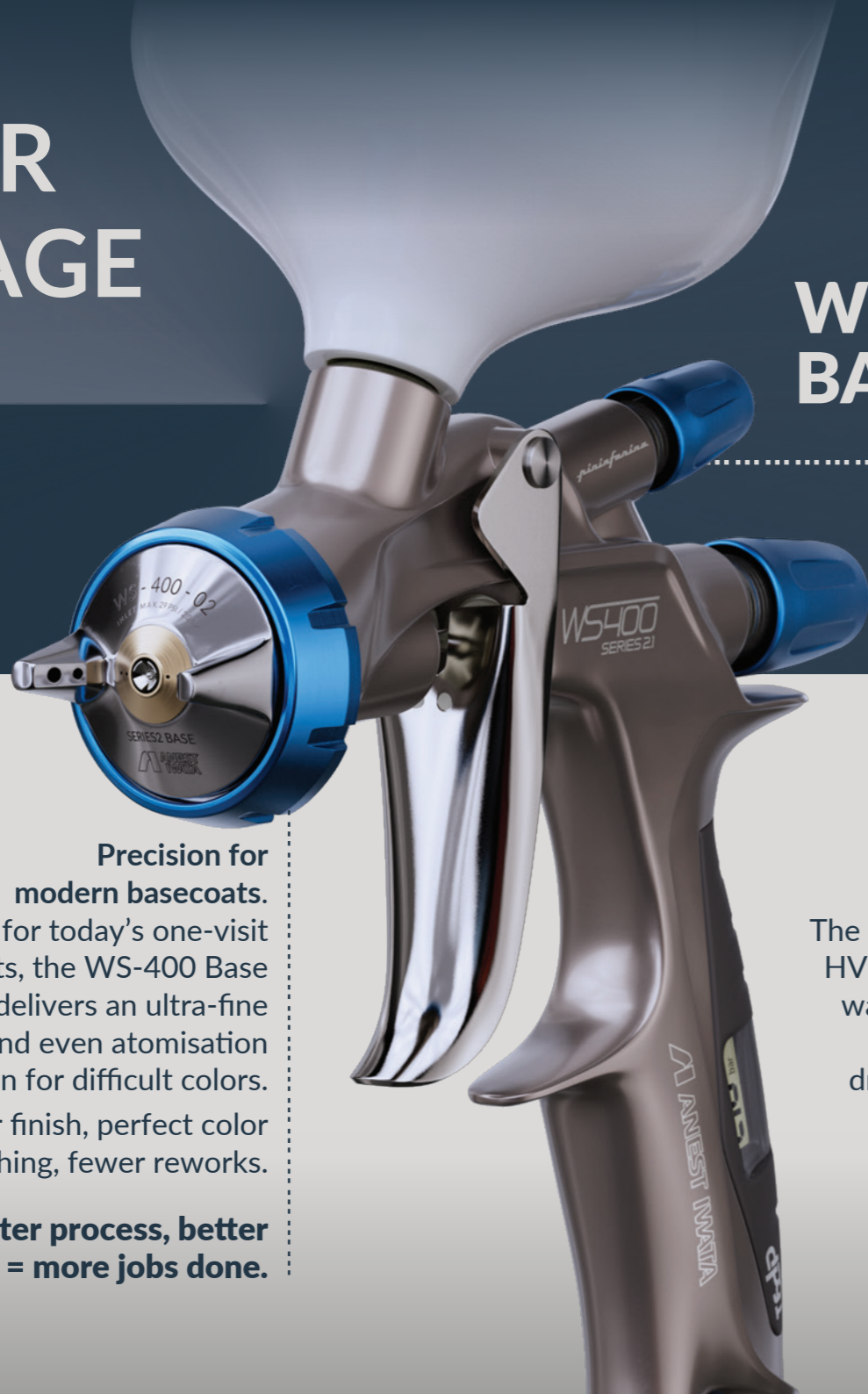

PRECISION, ENGINEERED

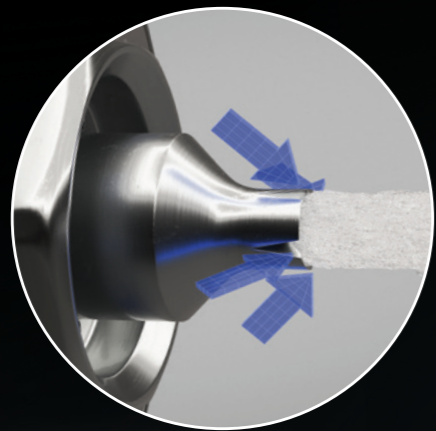

Split Nozzle™ 2.0 Technology

When you need a stable, predictable atomisation: this is where it starts.

Split Nozzle™ 2.0 is the result of years of development and testing, designed for professionals who demand control, consistency, and precision. Its four precision-cut slits direct the airflow into the material stream, **enhancing atomisation at its core**. The result: fine and even droplets, a flat and precise fan pattern, and high-transfer performance, even in tough conditions.

Consistent results, coat after coat.



Balanced
Application



Low
Consumption



Consistent
Control



DIGITAL MADE SIMPLE



DPG-1 Digital Gauge System

Precision pressure control, built right in.

The DPG-1 is a **compact, quick-detachable digital gauge** that integrates seamlessly with WS/LS spray guns; **no added weight**, no compromise on balance or ergonomics. Its **Click-Mag System** allows for fast removal during cleaning, while the pressure sensor is perfectly placed for reliable, **real-time accuracy**. Smart features like auto on/off and low-battery alerts make every spray gun session a blast.

Accuracy, without compromise.



The Click-Mag System



User-replaceable battery



FLOW-STATE ENGINEERING

Enter the zone.
Perfect every motion.

Series 2.1 integrates every element to **reduce friction** and **keep your work seamless**. Every detail is designed to support **sustained focus** and **effortless precision**, so your workflow stays smooth, results consistent, and **satisfaction grows** with every task.



Non-removable airflow baffle
Stability built in.

Fixed by design, it eliminates movement and wear points, ensuring consistent atomization and long-term reliability without adjustment.



Gasketless Dual-Taper Nozzle
Precision sealed, every time.

The dual-taper geometry ensures a secure, leak-free fit without gaskets, removing uncertainty and reducing maintenance over time.

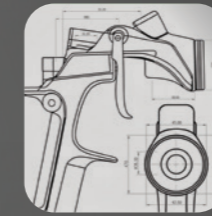

Optimised Body and Controls
Ergonomics without compromise.

Its refined geometry and compact form reduce weight and improve balance. Redesigned adjusters ensure precise, comfortable control. Less strain, better handling, hour after hour.



Smooth, Low-Resistance Trigger
Precision at your fingertips.

Engineered for comfort and control, the trigger responds with just the right resistance, ensuring accurate and repeatable application without effort.



Conical Air Cap
Designed for lasting precision.

The conical shape reduces paint build-up over time, assuring consistent spray performance to meet highest demands.



EVERY
ELEMENT
IN SYNC.
EXCELLENCE
FOLLOWS.

SUSTAINABLE BY DESIGN

Purpose-built. Responsible by nature.

At Anest Iwata, sustainability is a function of precision. Series 2.1 integrates material efficiency, durability, and maintainability into every component, minimising waste and maximising long-term performance, engineered through **four targeted sustainability principles**.

LONG-LASTING SPRAY GUNS



Our spray guns are designed to endure over time.

Reduced need for frequent replacements.

Cut down on material consumption and waste.

COMPLETE PARTS ACCESS



We offer a wide range of spray gun spare parts.

Easy repairs reduce full replacements.

Repairability optimizes resource use.

OPTIMIZED PAINT PROCESS



Reduction in processing time.

Decrease in the amount of material used.

Optimized work experience.

SUSTAINABLE PACKAGING



Our cardboard box is simple and fully recyclable.

The internal tray is crafted from fully reclaimed sugarcane pulp.

Printed manuals are minimized.



SAVE TIME.
SAVE MONEY.
SAVE ENVIRONMENT.

PRECISION, PRECONFIGURED



Each task, precisely matched.

Every Series 2.1 model is delivered in a dedicated version, configured for a specific material or application. No adjustments needed, just consistent performance from the first use.

SUPERIOR SET



TWO SERIES 2.1 SPRAY GUNS
TWO 600 ML GRAVITY CUPS
CLEANING BRUSHES
UNIVERSAL SPANNER

DIGITAL VERSION:
AIR DISTRIBUTION PLUG/PIN CAP
NON-DIGITAL VERSION:
HVC AIR PRESSURE REGULATOR.

PRO SET



Digital version: WS-400/LS-400 Series 2.1 Digital Spray Gun - 600 ml Gravity Cup - DPG-1 Module - Cleaning Brushes - Universal Spanner - Air distribution plug/Pin Cap. **Standard version:** WS-400/LS-400 Series 2.1 Spray Gun 600 ml Gravity Cup - HVC Air Pressure Regulator - Cleaning Brushes - Universal Spanner.

ECO SET



WS-400/LS-400 Series 2.1 Non Digital Spray Gun - 600 ml Gravity Cup - Cleaning Brushes
Universal Spanner.

 **RIGHT SETUP. RIGHT OUTCOME.**

TECHNICAL SPECIFICATIONS

ORDER INFORMATION

SUPERIOR SET COMBINATION CHART



WS-400 SERIES 2.1 BASE • Air Nipple: G1/4" • Fluid Nipple: G1/4"

Setup	Type	Description/Climate*	Model Name Digital/Non-digital	Cap	Air pressure Bar**	Air consumption NI/min	Pattern width mm***
OBS	1.3 OBS-0	HUMID	WS-400-SR2.1D-OBS-0 WS-400-SR2.1-OBS-0	WS-400-02-OBS	2.0	370	255
	1.3 OBS	STANDARD*	WS-400-SR2.1D-OBS WS-400-SR2.1-OBS				255
	1.3 OBS+1	DRY	WS-400-SR2.1D-OBS+1 WS-400-SR2.1-OBS+1				260
BF	BF-S	STANDARD*	WS-400-SR2.1D-BF-S WS-400-SR2.1-BF-S	WS-400-03-BF	2.0	370	250
	BF-40	DRY	WS-400-SR2.1D-BF-40 WS-400-SR2.1-BF-40				260
	1.4 HD	STANDARD*	WS-400-SR2.1D-BF-14HD WS-400-SR2.1-BF-14HD				255

* OBS series: for type A wet on wet application • BF series: for type B wet on wet application *Standard climate range: 15-30°C with a humidity of 30% - 75% RH. **Suggested gun inlet pressure during spraying. ***Fan width at a Spray distance of 150 mm.

LS-400 SERIES 2.1 BASE • Air Nipple: G1/4" • Fluid Nipple: G1/4"

Setup	Type	Application speed	Model Name Digital/Non-digital	Cap	Air pressure Bar**	Air consumption NI/min	Pattern width mm***
ET - Standard	1.2 ET	CONTROL	LS-400-SR2.1D-1206 LS-400-SR2.1-1206	LS-400-06	1.8	400	230
	1.3 ET	STANDARD	LS-400-SR2.1D-1306 LS-400-SR2.1-1306				235
	1.4 ET	SPEED	LS-400-SR2.1D-1406 LS-400-SR2.1-1406				240
	1.5 ET	HIGH SPEED	LS-400-SR2.1D-1506 LS-400-SR2.1-1506				245
ETS - Dry	1.2 ETS	CONTROL	LS-400-SR2.1D-12S06 LS-400-SR2.1-12S06	LS-400-06	1.8	420	200
	1.3 ETS	STANDARD	LS-400-SR2.1D-13S06 LS-400-SR2.1-13S06				205
	1.4 ETS	SPEED	LS-400-SR2.1D-14S06 LS-400-SR2.1-14S06				210
	1.5 ETS	HIGH SPEED	LS-400-SR2.1D-15S06 LS-400-SR2.1-15S06				215

* ET series: for standard climate application • ETS series: for dry climate application **Suggested gun inlet pressure during spraying. ***Fan width at a Spray distance of 150 mm.

WS-400 SERIES 2.1 CLEAR • HD (High Delivery) • Air Nipple: G1/4" • Fluid Nipple: G1/4"

Setup	Type	Application speed	Model Name Digital/Non-digital	Cap	Air pressure Bar**	Air consumption NI/min	Pattern width mm***
HD	1.2 HD	CONTROL	WS-400-SR2.1D-12HD WS-400-SR2.1-12HD	WS-400-03	2.0	370	245
	1.3 HD	STANDARD	WS-400-SR2.1D-13HD WS-400-SR2.1-13HD				250
	1.4 HD	SPEED	WS-400-SR2.1D-14HD WS-400-SR2.1-14HD				255
	1.5 HD	HIGH SPEED	WS-400-SR2.1D-15HD WS-400-SR2.1-15HD				260

Suggested gun inlet pressure during spraying. *Fan width at a Spray distance of 150 mm.

WS-400 SR2.1 BASE DIGITAL	1.3 OBS-0	1.3 OBS	1.3 OBS+1	BF-S	BF-40	1.4 HD
PRO SET	130189A1	130190A1	130191A1	130250A1	130644A1	130951A1
SUPERIOR SET	See next page for the full range of available combinations.					
WS-400 SR2.1 BASE	1.3 OBS-0	1.3 OBS	1.3 OBS+1	BF-S	BF-40	1.4 HD
PRO SET	130611A1	130612A1	130613A1	130614A1	130643A1	130950A1
ECO SET	130256A1	130257A1	130258A1	130259A1	130260A1	130949A1
SUPERIOR SET	See next page for the full range of available combinations.					
AIR CAP SET	93008310			93018140		
FLUID NOZZLE & NEEDLE	93008930	93008340	93008990	93018150	93021390	93009160

LS-400 SR2.1 BASE DIGITAL	1.2 ET	1.3 ET	1.4 ET	1.5 ET	1.2 ETS	1.3 ETS	1.4 ETS	1.5 ETS
PRO SET	130213A1	130214A1	130215A1	130216A1	130217A1	130218A1	130219A1	130220A1
SUPERIOR SET	See next page for the full range of available combinations.							
LS-400 SR2.1 BASE	1.2 ET	1.3 ET	1.4 ET	1.5 ET	1.2 ETS	1.3 ETS	1.4 ETS	1.5 ETS
PRO SET	130619A1	130620A1	130621A1	130622A1	130623A1	130624A1	130625A1	130626A1
ECO SET	130265A1	130266A1	130267A1	130268A1	130269A1	130270A1	130271A1	130272A1
SUPERIOR SET	See next page for the full range of available combinations.							
AIR CAP SET	93008030							
FLUID NOZZLE & NEEDLE	93008160	93008070	93008180	93008200	93008230	93008250	93008270	93008290

WS-400 SR2.1 CLEAR DIGITAL	1.2 HD	1.3 HD	1.4 HD	1.5 HD
PRO SET	130193A1	130194A1	130195A1	130196A1
SUPERIOR SET	See next page for the full range of available combinations.			
WS-400 SR2.1 CLEAR	1.2 HD	1.3 HD	1.4 HD	1.5 HD
PRO SET	130615A1	130616A1	130617A1	130618A1
ECO SET	130261A1	130262A1	130263A1	130264A1
SUPERIOR SET	See next page for the full range of available combinations.			
AIR CAP SET	93009030			
FLUID NOZZLE & NEEDLE	93009140	93009060	93009160	93009180

The Superior Set is the perfect kit for any spray painter: two complete Series 2.1 spray guns packed in a durable, high-quality case. Choose between digital spray guns (with DPG-1 module) or standard ones (with HVC Air Pressure Regulator). To find your set code, simply match your two chosen models in the chart (rows and columns).

		PICK YOUR CLEARCOAT SPRAY GUN							
		WS-400 SERIES 2.1 CLEAR 1.2 HD		WS-400 SERIES 2.1 CLEAR 1.3 HD		WS-400 SERIES 2.1 CLEAR 1.4 HD		WS-400 SERIES 2.1 CLEAR 1.5 HD	
		STANDARD	DIGITAL	STANDARD	DIGITAL	STANDARD	DIGITAL	STANDARD	DIGITAL
WS-400 SERIES 2.1 BASE 1.3 OBS	STANDARD	130283A1SS	130283A1SD	130284A1SS	130284A1SD	130285A1SS	130285A1SD	130286A1SS	130286A1SD
	DIGITAL	130283A1DS	130283A1DD	130284A1DS	130284A1DD	130285A1DS	130285A1DD	130286A1DS	130286A1DD
WS-400 SERIES 2.1 BASE 1.3 OBS-0	STANDARD	130274A1SS	130274A1SD	130275A1SS	130275A1SD	130276A1SS	130276A1SD	130277A1SS	130277A1SD
	DIGITAL	130274A1DS	130274A1DD	130275A1DS	130275A1DD	130276A1DS	130276A1DD	130277A1DS	130277A1DD
WS-400 SERIES 2.1 BASE 1.3 OBS+1	STANDARD	130291A1SS	130291A1SD	130292A1SS	130292A1SD	130293A1SS	130293A1SD	130294A1SS	130294A1SD
	DIGITAL	130291A1DS	130291A1DD	130292A1DS	130292A1DD	130293A1DS	130293A1DD	130294A1DS	130294A1DD
WS-400 SERIES 2.1 BASE BF-S	STANDARD	130300A1SS	130300A1SD	130301A1SS	130301A1SD	130302A1SS	130302A1SD	130303A1SS	130303A1SD
	DIGITAL	130300A1DS	130300A1DD	130301A1DS	130301A1DD	130302A1DS	130302A1DD	130303A1DS	130303A1DD
WS-400 SERIES 2.1 BASE BF-40	STANDARD	130312A1SS	130312A1SD	130313A1SS	130313A1SD	130314A1SS	130314A1SD	130315A1SS	130315A1SD
	DIGITAL	130312A1DS	130312A1DD	130313A1DS	130313A1DD	130314A1DS	130314A1DD	130315A1DS	130315A1DD
LS-400 SERIES 2.1 BASE 1.2 ET	STANDARD	130327A1SS	130327A1SD	130337A1SS	130337A1SD	130346A1SS	130346A1SD	130354A1SS	130354A1SD
	DIGITAL	130327A1DS	130327A1DD	130337A1DS	130337A1DD	130346A1DS	130346A1DD	130354A1DS	130354A1DD
LS-400 SERIES 2.1 BASE 1.3 ET	STANDARD	130328A1SS	130328A1SD	130338A1SS	130338A1SD	130347A1SS	130347A1SD	130355A1SS	130355A1SD
	DIGITAL	130328A1DS	130328A1DD	130338A1DS	130338A1DD	130347A1DS	130347A1DD	130355A1DS	130355A1DD
LS-400 SERIES 2.1 BASE 1.4 ET	STANDARD	130329A1SS	130329A1SD	130339A1SS	130339A1SD	130348A1SS	130348A1SD	130356A1SS	130356A1SD
	DIGITAL	130329A1DS	130329A1DD	130339A1DS	130339A1DD	130348A1DS	130348A1DD	130356A1DS	130356A1DD
LS-400 SERIES 2.1 BASE 1.5 ET	STANDARD	130330A1SS	130330A1SD	130340A1SS	130340A1SD	130349A1SS	130349A1SD	130357A1SS	130357A1SD
	DIGITAL	130330A1DS	130330A1DD	130340A1DS	130340A1DD	130349A1DS	130349A1DD	130357A1DS	130357A1DD
LS-400 SERIES 2.1 BASE 1.2 ETS	STANDARD	130331A1SS	130331A1SD	130341A1SS	130341A1SD	130350A1SS	130350A1SD	130358A1SS	130358A1SD
	DIGITAL	130331A1DS	130331A1DD	130341A1DS	130341A1DD	130350A1DS	130350A1DD	130358A1DS	130358A1DD
LS-400 SERIES 2.1 BASE 1.3 ETS	STANDARD	130332A1SS	130332A1SD	130342A1SS	130342A1SD	130351A1SS	130351A1SD	130359A1SS	130359A1SD
	DIGITAL	130332A1DS	130332A1DD	130342A1DS	130342A1DD	130351A1DS	130351A1DD	130359A1DS	130359A1DD
LS-400 SERIES 2.1 BASE 1.4 ETS	STANDARD	130333A1SS	130333A1SD	130343A1SS	130343A1SD	130352A1SS	130352A1SD	130360A1SS	130360A1SD
	DIGITAL	130333A1DS	130333A1DD	130343A1DS	130343A1DD	130352A1DS	130352A1DD	130360A1DS	130360A1DD
LS-400 SERIES 2.1 BASE 1.5 ETS	STANDARD	130334A1SS	130334A1SD	130344A1SS	130344A1SD	130353A1SS	130353A1SD	130361A1SS	130361A1SD
	DIGITAL	130334A1DS	130334A1DD	130344A1DS	130344A1DD	130353A1DS	130353A1DD	130361A1DS	130361A1DD

PICK YOUR BASECOAT SPRAY GUN

PICK YOUR BASECOAT GUN



FROM PRECISION TO PERFECTION. YOUR CALL.



SERIES 2.1



Explore the evolution of precision:
the WS/LS-400 Series 2.1.
Scan the QR-Code or visit
<https://l.ead.me/bfqk6i>
from your device for comprehensive support.

www.anest-iwata-coating.com